

## Carpet Poles

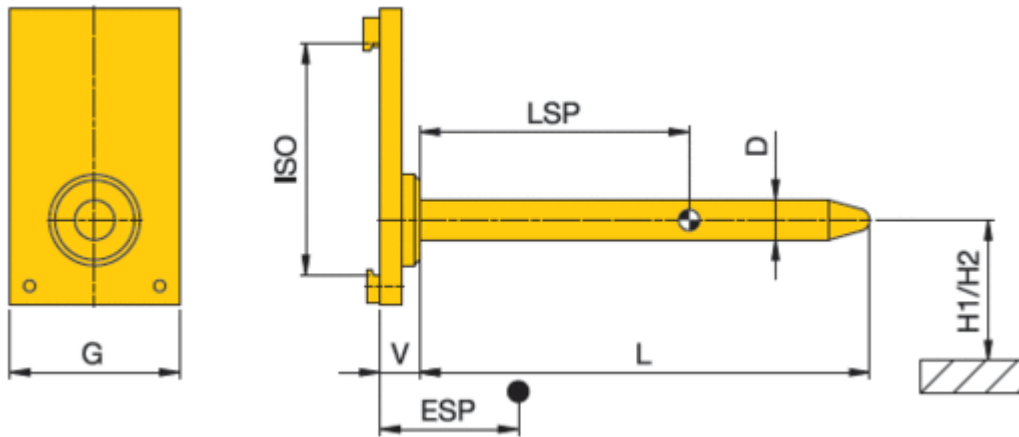

## Material 42CrMo4

Model	Load capacity kg at ... mm LC (LSP)							D	G	H1/H2	ISO	V	CoG (ESP) at L=2000 mm	Weight at L=2000 mm	Additional weight per 100 mm add. length
	500	1000	1250	1500	1750	2000	2500								
S 2 - TD 010- 50	500	250	200	165	140	125	100	50	300	170/250	2	65	405	85	1,5
S 2 - TD 015- 55	700	350	280	230	200	175	140	55	300	170/250	2	65	450	90	1,9
S 2 - TD 020- 60	950	475	380	315	270	235	190	60	300	170/250	2	70	465	105	2,2
S 2 - TD 025- 65	1250	625	500	415	355	310	250	65	300	170/250	2	70	505	110	2,6
S 2 - TD 030- 70	1500	700	600	500	425	375	300	70	300	170/250	2	70	545	120	3,0
S 2 - TD 040- 75	1900	950	760	630	540	475	380	75	300	170/250	2	70	580	130	3,5
S 2 - TD 050- 80	2400	1200	960	800	680	600	500	80	400	170/250	2	80	525	165	3,9
S 2 - TD 055- 85	2750	1375	1100	915	785	685	550	85	400	170/250	2	80	555	175	4,5
S 2 - TD 060- 90	3000	1500	1200	1000	855	750	600	90	400	170/250	2/3	85	565	195	5,0
S 2 - TD 070- 95	3500	1750	1400	1165	1000	875	700	95	400	170/250	2/3	85	590	210	5,6
S 2 - TD 080-100	4000	2000	1600	1330	1140	1000	800	100	400	170/300	3	95	535	255	6,2
S 2 - TD 105-110	5250	2625	2100	1750	1500	1310	1050	110	400	170/300	3	95	580	290	7,5
S 2 - TD 140-120	7000	3500	2800	2350	2000	1750	1400	120	600	300/430	3/4	105	440	470	8,9

- H1 applies to ISO A / H2 applies to ISO B

- Surcharge for QD hooks for quick mounting of the attachment for ISO 2
- Surcharge for QD hooks for quick mounting of the attachment for ISO 3
- Surcharge for QD hooks for quick mounting of the attachment for ISO 4
- Surcharge for slip-on version (please indicate max. outer diameter)

## Standard values for residual load capacity of lift trucks\*\*

Carpet Poles	S 2 -	TD 025 -65	TD 030 -70	TD 040 -75	TD 050 -80	TD 070 -95	TD 080 -100	TD 105 -110	TD 105 -110	TD 140 -120	TD 140 -120
Load Capacity lift truck	kg	1000	1200	1500	2000	2500	3000	3500	4000	4500	5000/500
X*	mm	300	350	350	450	450	450	500	500	500	500
LC (LSP) = 2000 mm	kg	290	370	465	(600)	870	1000	1210	(1310)	1550	(1750)
LC (LSP) = 2500 mm	kg	220	285	360	(500)	700	800	970	(1050)	1240	(1400)

\*\* The load capacity applies to lifting heights up to 3300 mm; specifications for greater lifting heights on request.

\* Assumed dimensions

For greater load centers, where the lift truck has a higher residual load capacity than the attachment, those values, upon the exceedance of which the attachment would be overloaded, are indicated in brackets ( ).

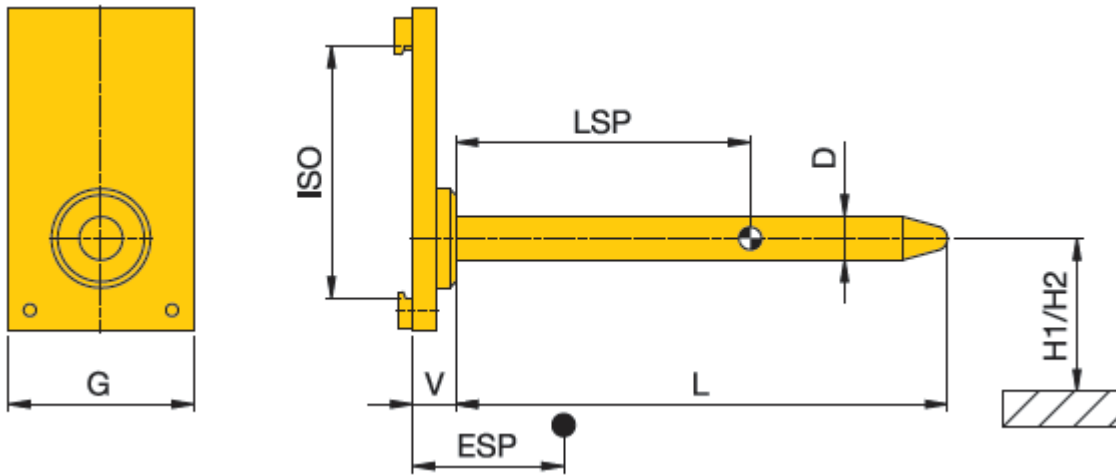

### Material 30CrNiMo8

Model	Load capacity kg at ... mm LC (LSP)							D	G	H1/H2	ISO	V	CoG (ESP) at L=2000 mm	Weight at L=2000 mm	Additional weight per 100 mm add. length
	500	1000	1250	1500	1750	2000	2500								
S 2 - TD 015- 50	650	325	260	215	185	160	130	50	300	170/250	2	65	405	85	1,5
S 2 - TD 020- 55	900	450	360	300	255	225	180	55	300	170/250	2	65	450	90	1,9
S 2 - TD 025- 60	1200	600	480	400	340	300	240	60	300	170/250	2	70	465	105	2,2
S 2 - TD 030- 65	1500	750	600	500	430	375	300	65	300	170/250	2	70	505	110	2,6
S 2 - TD 040- 70	2000	1000	800	665	570	500	400	70	300	170/250	2	70	545	120	3,0
S 2 - TD 050- 75	2450	1225	980	815	700	610	490	75	300	170/250	2	70	580	130	3,5
S 2 - TD 060- 80	3000	1500	1200	1000	855	750	600	80	400	170/250	2/3	80	525	165	3,9
S 2 - TD 070- 85	3600	1800	1440	1200	1025	900	720	85	400	170/250	2/3	80	555	175	4,5
S 2 - TD 080- 90	4000	2000	1600	1330	1140	1000	800	90	400	170/250	3	85	565	195	5,0
S 2 - TD 095- 95	4750	2375	1900	1580	1355	1185	950	95	400	170/250	3	85	590	210	5,6
S 2 - TD 110-100	5500	2750	2200	1830	1570	1375	1100	100	400	170/300	3	95	535	255	6,2
S 2 - TD 140-110	7000	3500	2800	2330	2000	1750	1400	110	400	170/300	3/4	95	580	290	7,5
S 2 - TD 180-120	9000	4500	3600	3000	2570	2250	1800	120	600	300/430	4	105	440	470	8,9

- H1 applies to ISO A / H2 applies to ISO B
- Surcharge for QD hooks for quick mounting of the attachment for ISO 2
- Surcharge for QD hooks for quick mounting of the attachment for ISO 3
- Surcharge for QD hooks for quick mounting of the attachment for ISO 4
- Surcharge for slip-on version (please indicate max. outer diameter)

### Standard values for residual load capacity of lift trucks\*\*

Carpet Poles	S 2 -	TD 025 -60	TD 030 -65	TD 040 -70	TD 060 -80	TD 070 -85	TD 080 -90	TD 110 -100	TD 110 -100	TD 140 -110	TD 140 -110	TD 180 -120
Load capacity lift truck	kg	1000	1200	1500	2000	2500	3000	3500	4000	4500	5000/500	5000
X*	mm	300	350	350	450	450	450	500	500	500	500	560
LC (LSP) = 2000 mm	kg	300	375	475	680	870	(1000)	1245	(1375)	1610	(1750)	2035
LC (LSP) = 2500 mm	kg	230	295	375	540	700	(800)	1005	(1100)	1300	(1400)	1650

\*\* The load capacity applies to lifting heights up to 3300 mm; specifications for greater lifting heights on request.

\* Assumed dimensions

For greater load centers, where the lift truck has a higher residual load capacity than the attachment, those values, upon the exceedance of which the attachment would be overloaded, are indicated in brackets ( ).

## Coil Booms

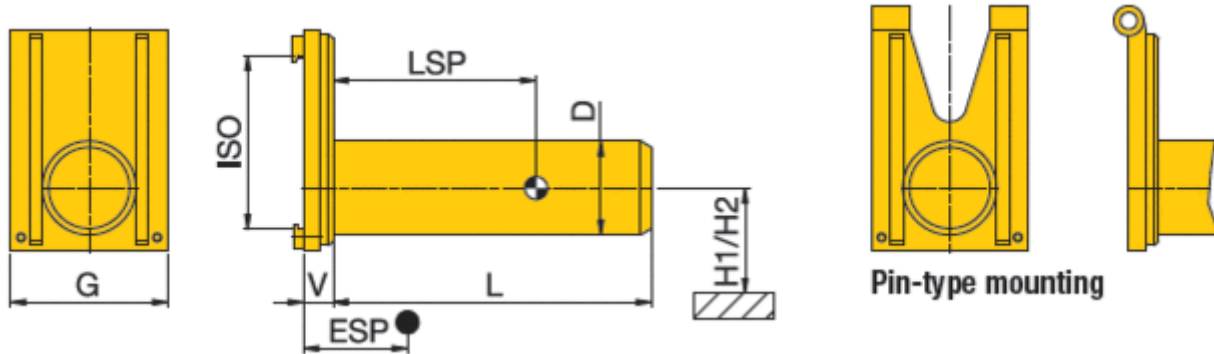

Model	Load capacity kg at ... mm LC (LSP)					D mm	L mm	G mm	H1/H2 mm	ISO	V mm	CoG (ESP) mm	Weight kg	Surcharge per 100 mm add. length kg
	500	600	800	1000	1200									
S 2 - D 15	1500	1250	940	750	625	115	1000	450	190/265	2	60	160	100	3,1
S 2 - D 25	2500	2085	1565	1250	1000	150	1000	450	190/265	2	70	185	135	4,3
S 2 - D 30	3000	2500	1875	1500	1250	150	1000	450	190/320	3	70	165	150	4,8
S 2 - D 40	4000	3335	2500	2000	1670	180	1000	500	220/350	3	85	190	215	5,7
S 2 - D 50		5000	3750	3000	2500	200	1000	600	290/415	4	90	170	330	7,0
S 2 - D 60		6000	4500	3600	3000	220	1000	600	295/420	4	100	175	370	8,0
S 2 - D 70		7000	5250	4000	3500	220	1000	600	295/420	4	100	190	390	8,7
S 2 - D 80		8000	6000	4800	4000	220	1000	800	380	4	110	160	510	9,8
S 2 - D 100		10000	7500	6000	5000	250	1000	800	405	4	130	160	600	11,1
S 2 - D 120		12000	9000	7200	6000	250	1000	900	405	4	130	170	765	13,5
S 2 - D 150		15000	11250	9000	7500	300	1000	900	430	Pint.	150	150	1020	13,8
S 2 - D 200		20000	15000	12000	10000	370	1000	900	470	Pint.	160	175	1235	17,2
S 2 - D 300		30000	22500	18000	15000	420	1000	1000	500	Pint.	180	175	1535	19,7
S 2 - D 400		40000	30000	24000	20000	510	1000	1000	550	Pint.	190	205	1890	29,7

- H1 applies to ISO A / H2 applies to ISO B

- Surcharge for QD hooks for quick mounting of the attachment for ISO 2

- Surcharge for QD hooks for quick mounting of the attachment for ISO 3

- Surcharge for QD hooks for quick mounting of the attachment for ISO 4

- Surcharge for slip-on version on request.

- Surcharge for protective modules on request.

## Standard values for residual load capacity of lift trucks\*\*

Coil Booms	S 2 -	D 15	D 25	D 25	D 30	D 40	D 40	D 50	D 60	D 70	D 80	D 100	D 120	D 150
Load capacity lift truck	kg	1500	2000	2500	3000	3500	4000	5000	6000	7000	8000	10000	12000	15000
X*	mm	350	450	450	450	500	500	560	560	650	650	750	800	850
LC (LSP) = 500 mm	kg	1460	1920	2420	2930	3330	3850							
LC (LSP) = 600 mm	kg	1300	1730	2190	2640	3020	3490	4830	5730	6790	7650	9540	11360	14140
LC (LSP) = 800 mm	kg	1060	1440	1820	2200	2530	2930	4100	4860	5780	6570	8280	9920	12440
LC (LSP) = 1000 mm	kg	890	1220	1550	1870	2170	2520	3540	4210	5060	5730	7300	8770	11030
LC (LSP) = 1200 mm	kg							3100	3690	4460	5060	6520	7830	9900
LC (LSP) = 1500 mm	kg							2590	3090	3790	4280	5560	6710	8550

\*\* The load capacity applies to lifting heights up to 3300 mm; specifications for greater lifting heights on request.

\* Assumed dimensions